

SANTOS ALUMINIUM GLASS DOORS

Available in Kitset (without glass) or pre-made with either obscure or clear toughened glass

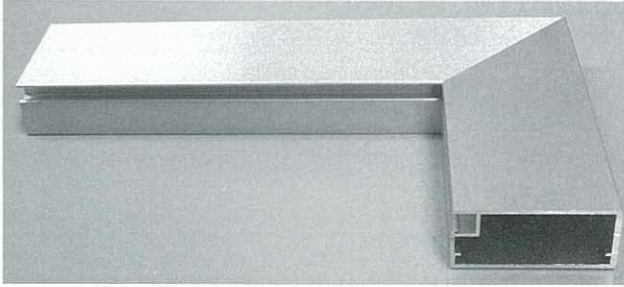

45 x 20 Frame

Code no.
4520

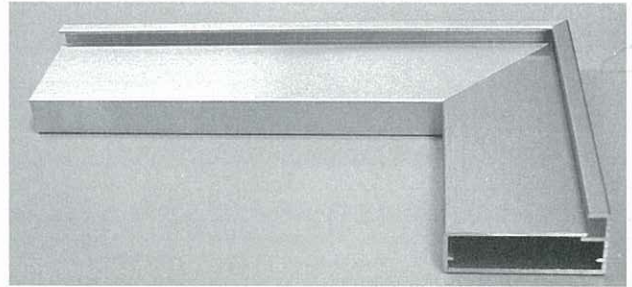
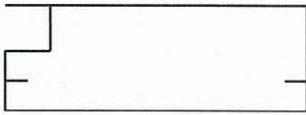

45 x 20 Frame

Code no.
8597

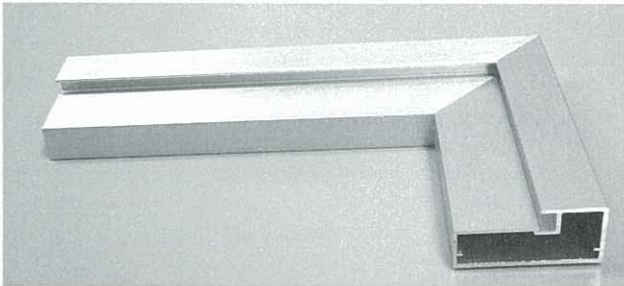
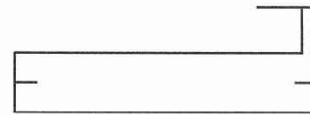

45 x 20 Frame

Code no.
8594

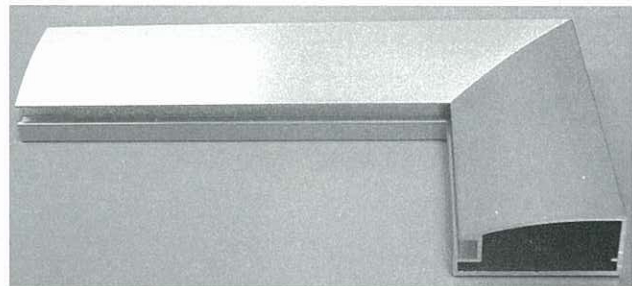
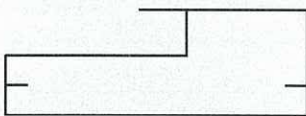

45 x 20 Frame

Code no.
8593



20 x 20 Curved Frame

Code no.
8598

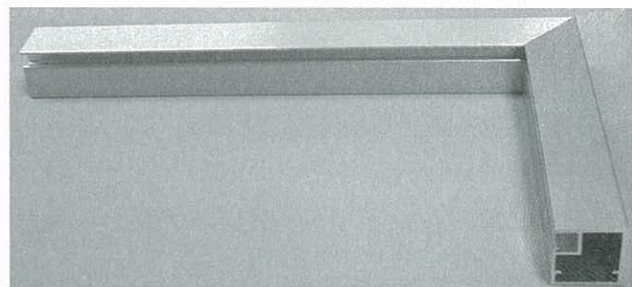
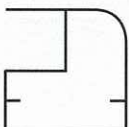

20 x 20 Square Frame

Code no.
2020

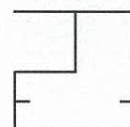

SANTOS ALUMINIUM FOR STANDARD and BIFOLD DOORS

COMPANY NAME _____

QUOTE/ORDER (Please Circle One)

CONTACT NAME _____

ORDER # _____

DELIVER TO _____

PHONE _____

FAX _____

Delivery Date approximately 20 working days from order receipt

Step One – Aluminium Profile (Please clearly circle one)

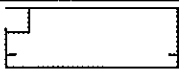

4520



Cross Rail for 4520



8594



8597



2020



8598

Step Two – Door Information

Tick appropriate box

| Door No. | Height | Width | Qty | Left Hand | Right Hand |
|----------|--------|-------|-----|-----------|------------|
| 1 | | | | | |
| 2 | | | | | |
| 3 | | | | | |
| 4 | | | | | |

| Std Door | Bi-Fold | Panel | Flap |
|--------------------------|--------------------------|--------------------------|--------------------------|
| <input type="checkbox"/> | <input type="checkbox"/> | <input type="checkbox"/> | <input type="checkbox"/> |
| <input type="checkbox"/> | <input type="checkbox"/> | <input type="checkbox"/> | <input type="checkbox"/> |
| <input type="checkbox"/> | <input type="checkbox"/> | <input type="checkbox"/> | <input type="checkbox"/> |
| <input type="checkbox"/> | <input type="checkbox"/> | <input type="checkbox"/> | <input type="checkbox"/> |

Step Three – Door Information Cont.

Work from top to bottom, left to right

| | | | |
|--------------------------------|-----------------------------------|---------------------------------------|--|
| Cabinet Panel Thickness | <input type="checkbox"/> 16mm | <input type="checkbox"/> 18mm | |
| Toughened Glass | <input type="checkbox"/> Clear | <input type="checkbox"/> Etchlite | <input type="checkbox"/> Drill Handle Holes in Glass (Supply Drawing) |
| Assembly | <input type="checkbox"/> Kitset | <input type="checkbox"/> Assembled | <input type="checkbox"/> Do not supply hinges |
| Hinges | <input type="checkbox"/> Full | <input type="checkbox"/> Half Overlay | <input type="checkbox"/> Inset <input type="checkbox"/> Hinge Milling Required |
| Hinges cont. | <input type="checkbox"/> Standard | <input type="checkbox"/> Unsprung | <input type="checkbox"/> Touch Open |
| BiFold (Sanco) | <input type="checkbox"/> Cupped | <input type="checkbox"/> Butt | Bi-fold Track Length 1.5m 2.0m (circle) |

Step Four – Hinge Position and Information

If you require different hinge positioning than shown to the right, please alter dimensions on this drawing. Additionally, if they alter per door, please send one order per door.

Glass Size Deductions:

- 2020 Overall Door less 28mm
- 4520 Overall Door less 82mm
- 8594 Overall Door less 33mm
- 8597 Overall Door less 6mm
- 8598 Overall Door less 28mm
- 8599 Overall Door less 35mm

DETAILED DRAWING MUST BE SUPPLIED SHOWING POSITION OF ANY HOLES REQUIRED IN THE GLASS

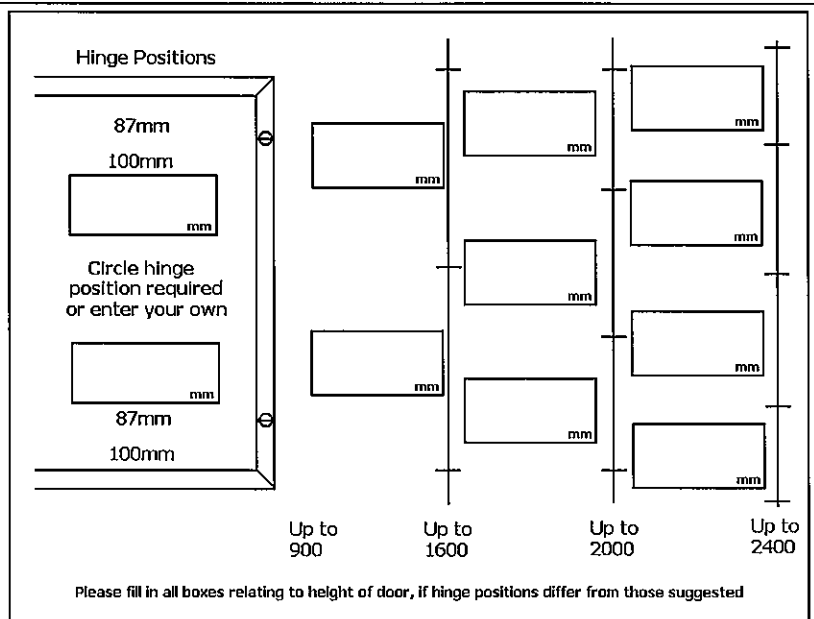

Comments:

SANTOS ALUMINIUM DOORS FOR AVENTOS

COMPANY NAME _____
 CONTACT NAME _____
 DELIVER TO _____

QUOTE/ORDER (Please Circle One)
 ORDER # _____
 PHONE _____
 FAX _____

Delivery Date approximately 20 working days from order receipt

Step One – Aluminium Profile (Please clearly circle one)

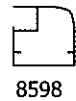
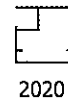
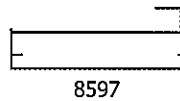
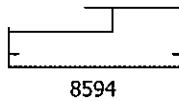
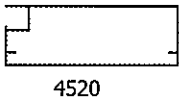

Step Two – Door Information

Tick appropriate box

| Door No. | Height | Width | Qty |
|----------|--------|-------|-----|
| 1 | | | |
| 2 | | | |
| 3 | | | |
| 4 | | | |



Step Three – Door Information Cont.

Work from top to bottom, left to right

Cabinet Panel Thickness 16mm 18mm
 Toughened Glass Clear Etchlite Drill Handle Holes in Glass (Supply Drawing)
 Assembly Kitset Assembled Do not supply hardware
 Hinge Milling Required? Yes No

Step Four – Hinge Position and Information

If you require different hinge positioning than shown to the right, please alter dimensions on this drawing. Additionally, if they alter per door, please send one order per door.

Glass Size Deductions:

- 2020 Overall Door less 28mm
- 8594 Overall Door less 33mm
- 8597 Overall Door less 6mm
- 8598 Overall Door less 28mm
- 8599 Overall Door less 35mm

Outside Hinge Locations

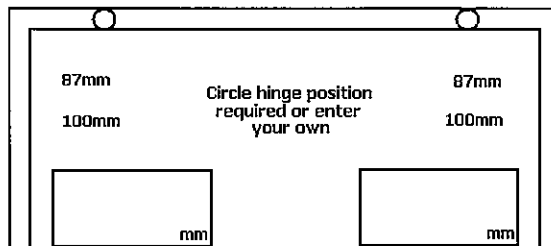

Please fill in all boxes relating to width of door, if hinge positions differ from those suggested

_____ 1200

| | | |
|----------|----------|----------|
| _____ mm | _____ mm | _____ mm |
|----------|----------|----------|

Up to 1800

| | | | |
|----------|----------|----------|----------|
| _____ mm | _____ mm | _____ mm | _____ mm |
|----------|----------|----------|----------|

DETAILED DRAWING MUST BE SUPPLIED SHOWING POSITION OF ANY HOLES REQUIRED IN THE GLASS

Comments